



**AP MORGAN**

**Oversley Mill Park, Oversley Green,**  
Offers in excess of £120,000

**Features:**

- Detached static park home
- Fitted kitchen with space for appliances
- Lounge with dual aspect windows and patio door
- Two bedrooms with space for wardrobes
- Bathroom
- Paved and patio garden space
- Off-road parking spaces
- Sought after Alcester location

**Description:**

A rare opportunity to acquire a detached static park home, occupying a delightful corner plot situated at the entrance to Oversley Mill Park, Alcester.

Externally, the property benefits from two private block-paved areas, providing off-road parking space, and a gated front and back garden entrance. The outdoor space is split level and laid to patio slabs, perfect for garden furniture, then a well-maintained lawn with a mature planted border, giving a private garden area.

The property is accessed via two sets of steps and opens onto the entrance hallway. The rest of the accommodation then comprises: Lounge with dual aspect windows and patio door, fitted kitchen with space for freestanding appliances, double bedroom one with a rear window and space for wardrobes, bedroom two/dressing room, and the bathroom, providing a bath with overhead shower, sink and WC.

Well positioned in Alcester, a delightful Roman market town with many local shops, restaurants and further amenities, along with well-regarded local schools, and Ragley Hall. Redditch Town Centre is a short ride away boasting a further assortment of amenities, the local railway station and Kingfisher Shopping Centre.



**Details:**

**Entrance Hall**

**Lounge** 11'5" x 9'6" (3.48m x 2.9m)

**Kitchen** 7'4" x 9'5" (2.24m x 2.87m)

**Bedroom One** 7'1" x 9'6" (2.16m x 2.9m)

**Bed Two/Store** 7'9" x 7' (2.36m x 2.13m)

**Bathroom** 4'1" x 7' (1.24m x 2.13m)

**EPC Rating:** To be confirmed

**Council Tax Band:** A (tbc by solicitors).

**Tenure:** Leasehold (tbc by solicitors).

For more information or to arrange a viewing, please call us on 01527 406 956.



## How can we help you?

### Need a mortgage?

We recommend Wiser Mortgage Advice. They will search the market for you to ensure you get the right lender and mortgage deal. They typically achieve mortgage offers much more quickly than if you were dealing with lenders directly. The initial appointment is free and without obligation. Call us on 01527 406 956, or visit their website for more information: [www.wisermortgageadvice.co.uk](http://www.wisermortgageadvice.co.uk)

### Property to sell?

If you need to sell a property in order to buy, you ideally need to be on the market at least (and preferably Sold STC) before viewing, otherwise you may lose out to other buyers when the right property comes along. In these circumstances we can get your property 'live' quickly. Just book a free valuation and we will visit your property and discuss your needs.

### Need a solicitor?

A good solicitor can save you literally weeks of time in the buying/selling process, reducing the stress levels of all involved. We will instruct a reputable firm that is competitive on cost and very reliable. Just ask for a quote.

### Need a removal company and storage?

A professional removal company takes the stress out of moving, knowing that your belongings are safe and insured far outweighs any small savings by trying to do it yourself or using a man-and-a-van service. We work closely with and recommend Cube Removals as the leading local firm. For peace of mind and a reliable service call them on 0800 193 0000 or visit their website, [cuberemovals.co.uk](http://cuberemovals.co.uk), to arrange a survey.

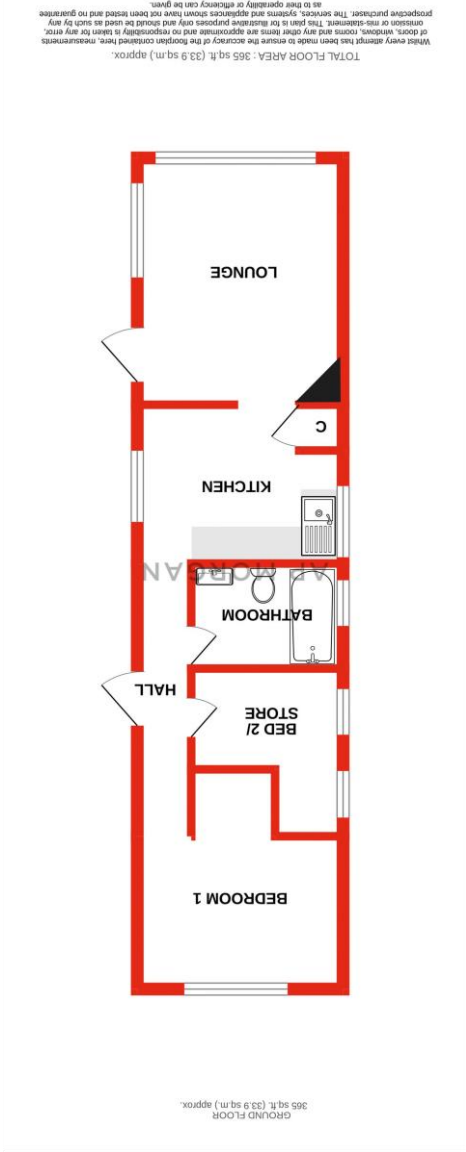

No statement in these details is to be relied upon as representation of fact, and purchasers should satisfy themselves by inspection or otherwise as to the accuracy of the statements contained within. These details do not constitute any part of any offer or contract. AP Morgan and their employees and agents do not have any authority to give any warranty or representation whatsoever in respect of this property. These details and all statements herein are provided without any responsibility on the part of AP Morgan or the vendors. Equipment: AP Morgan has not tested the equipment or central heating system mentioned in these particulars and the purchasers are advised to satisfy themselves as to the working order and condition. Measurements: Great care is taken when measuring, but measurements should not be relied upon for ordering carpets, equipment, etc. The Laws of Copyright protect this material. AP Morgan is the Owner of the copyright. This property sheet forms part of our database and is protected by the database right and copyright laws. No unauthorised copying or distribution without permission.